

EMERGENCY PROCEDURES

Do you have . . .

- Emergency phone numbers and other important information posted close to your phone?
- An emergency escape plan for your home—and practice it often? If you live with others, does it include an outdoor meeting place?
- Alternate routes for your escape, if the main routes are blocked?

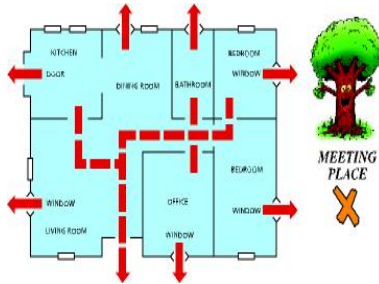

When you report a fire . . .

- Give your name and telephone number.
- Identify the problem—fire, number of people trapped, etc.
- Provide address and location—including house number, street name and municipality.



SMOKE DETECTORS

Have you installed smoke detectors . . .

- On each level of your home?
- On the ceiling just outside your bedroom door?
- In rooms frequently used by smokers?

Do you . . .

- Test battery-operated smoke detectors every month?
- Change smoke detector batteries each year?

**Protect your loved ones from burns.
Share this information with your
family and friends.**



Burn Prevention Foundation
236 N. 17th. Street, Floor 2
Allentown, PA 18104

Email: burnprev@fast.net
www.burnprevention.org

Phone: 610-969-3930
Fax: 610-969-3940

Burn Prevention Foundation



Fire and Burn Prevention CHECKLIST

Most burn injuries happen in the home. This checklist will help you evaluate your home environment and develop good fire and burn safety habits.





Fire and Burn Prevention CHECKLIST

KITCHEN

Do you ...

- Avoid wearing loose-fitting long sleeves when cooking?
- Know what to do if your clothing should catch fire? (Drop, Roll, Cool)
- Have good lighting in kitchen and work areas?
- Always keep pot handles turned inward?
- Keep a large lid within reach when frying, to extinguish grease fires?
- Use large potholders or oven mitts?
- Avoid leaving food to cook unattended?
- Keep children and toys out of pathways when carrying hot liquids?



ELECTRICAL APPLIANCES

Do you ...

- Dry your hands before using electrical appliances?
- Use electrical appliances on dry surfaces—away from water?
- Unplug appliances when not in use?
- Check lamp and appliance cords for fraying and/or brittle insulation?
- Replace worn cords and appliances?

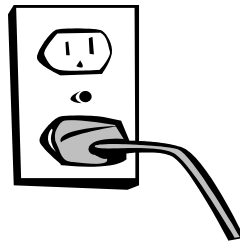
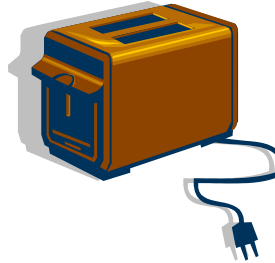

- Avoid overloading outlets?
- Use properly rated extension cords for indoor or outdoor use?

SMOKING MATERIALS

Do you ...

- Use caution with smoking materials?
- Avoid smoking when in bed, tired, ill, or when consuming alcohol or medication that makes you drowsy?



- Use large, sturdy ashtrays with flat, non-slip bottoms?
- Have safe ashtrays in all smoking areas?
- Have smoke detectors in rooms frequently used by smokers?
- Empty ashtrays into a metal container?
- Check the area for lit cigarettes and/or ashes after people who have been smoking leave the room?
- Keep all matches and lighters out of the reach of children?**

HOUSEKEEPING

Do you ...

- Keep fire escape routes free of clutter?
- Store combustibles/flammable materials such as paint thinner and solvents in original, tightly-closed containers, away from ignition sources?
- Store fuel such as kerosene and gasoline in proper containers outdoors only?

- Unplug all electrical tools when not in use?

